

1122 Gate Valve Handwheel PN20 - (brass)

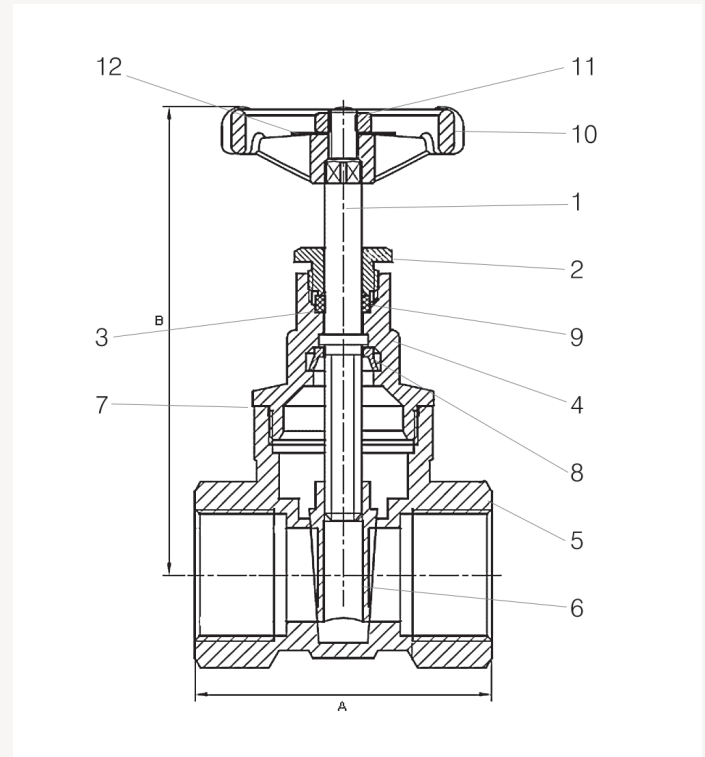

Material specification

1122 Handwheel version 1/2" to 4"

No	Component	Material	Specification
1	Stem	Brass	EN 12164 CW617N-DW
2	Packing nut	Brass	EN 12164 CW614N
3	Packing	PTFE	PTFE
4	Bonnet	Brass	EN 12165 CW617N-DW
5	Body	Brass	EN 12165 CW617N-DW
6	Wedge	Brass	EN 12165 CW617N-DW
7	Seal	PTFE	PTFE
8	Stem retainer	DZR brass	EN 12164 CW602N
9	Packing ring	Brass	EN 12164 CW614N
10	Handwheel	Aluminium	EN 1706 LM6
11	Handwheel nut	Brass	EN 12164 CW614N
12	Identity disc	Aluminium	EN 1706 LM6

Gate valves are designed for services that only need infrequent operation, where the gate is maintained at either fully open or fully closed. They should not be used for throttling the flow of fluid.

Features and benefits:

- High quality brass construction.
- Non-rising stem.
- End connections, female taper threads to EN 10226-2 (ISO 7-1) and parallel threads to ISO 228.
- WRAS approved for drinking water systems.
- Suitable for low temperature hot water systems.
- Unique Conex Bänninger handwheel.

1122 Gate Valve

Order code EN 10226-2 (ISO 7-1) thread	Order code ISO 228 thread	Size	DN	A	B	Kv value	Weight (kg)
112210RRW200404	112210FFW200404	1/2"	15	55	85	16	0.28
112210RRW200606	112210FFW200606	3/4"	20	60	95	32	0.40
112210RRW200808	112210FFW200808	1"	25	70	115	52	0.57
112210RRW201010	112210FFW201010	1.1/4"	32	75	125	100	0.96
112210RRW201212	112210FFW201212	1.1/2"	40	80	145	172	1.13
112210RRW201616	112210FFW201616	2"	50	90	165	230	1.9
112210RRW202020*	112210FFW202020*	2.1/2"	65	100	210	-	3.07
112210RRW202424*	112210FFW202424*	3"	80	115	240	-	4.40
112210RRW203232*	112210FFW203232*	4"	100	135	290	-	7.95

*Valves available to special order.

Valve suitability

Product	Steam	Water	Drinking water	Oil	Air (oil free)	Gas (inert)	Gas (combustible)	Gas (corrosive)	Gas (oxygen)
1122	x	✓	✓	✓	x	x	x	x	x

Max. working parameters

1122	Temperature °C	Pressure bar	Pressure psi
Water	-10 to +100	20	290

Specification clauses:

- Handwheel operated.
- Non-rising stem.
- Brass threaded bonnet and one piece wedge.
- End connections, female taper threads to EN 10226-2 (ISO 7-1) and parallel threads to ISO 228.
- WRAS approved for drinking water systems.
- Suitable for low temperature hot water systems.

