

CVDD Dual Plate Check Valve PN16 flanged

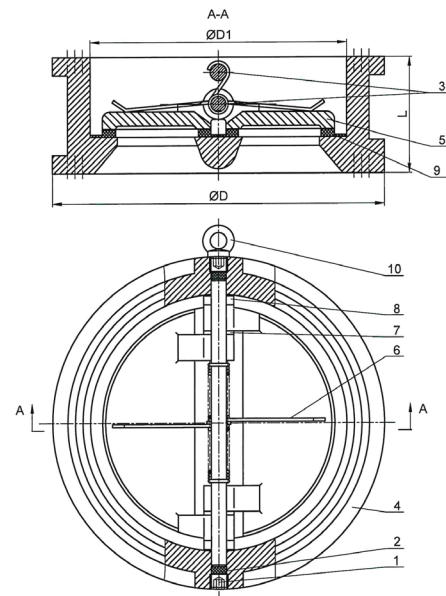

Drawing details representative of DN 50 to DN 300 valve construction. For details of valve construction for sizes DN350 to DN 600 please contact your local Conex Bänninger representative.

Material specification

CVDD Dual Plate Check Valve Flanged 2" to 24"

No	Component	Material
1	Screw	Carbon steel
2	Sealing ring	EPDM
3	Shaft	Stainless steel SS316
4	Body	Ductile iron
5	Disc	CF8/DI*/CF8M*/C95400*
6	Spring	Stainless steel SS316
7	Gasket	PTFE
8	Gasket	PTFE
9	Seat	EPDM
10	Lifting ring (for 8" and above)	Carbon steel

*Variants available to special order. Please contact your local Conex Bänninger representative.

Material details representative of DN 50 to DN 300 valve construction. For details of valve construction for sizes DN350 to DN 600 please contact your local Conex Bänninger representative

Applicable standards:

- Connection standard: EN 1092-2.
- Pressure test standard: EN 12266.
- Face to face standard: EN 558.

Technical data:

- Size: DN 50 – DN 600 (2" - 24").
- Nominal pressure: PN16.
- Shell test pressure: 24 bar.
- Seal test pressure: 17.6 bar.
- Temperature range: -20 °C to 110 °C.
- Suitable for water.

Features and benefits:

- Suitable for horizontal and vertical installation.
- Suitable for water applications.
- Available in sizes 2 - 24"
- Manufactured from high quality ductile iron.
- Designed and manufactured in accordance with EN 1092-2.

CVDD Dual Plate Check Valve Flanged 2" to 24"

Order Code	Size	DN	L	Ød1	Ød
C0050CWCMN16SO	2"	50	43	65	103
C0065CWCMN16SO	2 1/2"	65	46	80	123
C0080CWCMN16SO	3"	80	64	94	142
C0100CWCMN16SO	4"	100	64	117	157
C0125CWCMN16SO	5"	125	70	145	192
C0150CWCMN16SO	6"	150	76	170	218
C0200CWCMN16SO	8"	200	89	224	268
C0250CWCMN16SO	10"	250	114	265	328
C0300CWCMN16SO	12"	300	114	310	380
C0350CWCMN16SO	14"	350	127	360	439
C0400CWCMN16SO	16"	400	140	410	490
C0450CWCMN16SO	18"	450	152	450	554
C0500CWCMN16SO	20"	500	152	505	616
C0600CWCMN16SO	24"	600	178	624	724

Variants with DI/CF8M/C94500 disc available to special order. Please contact your local Conex Bänninger representative.