

CVSF Flex Swing Check Valve PN16 flanged

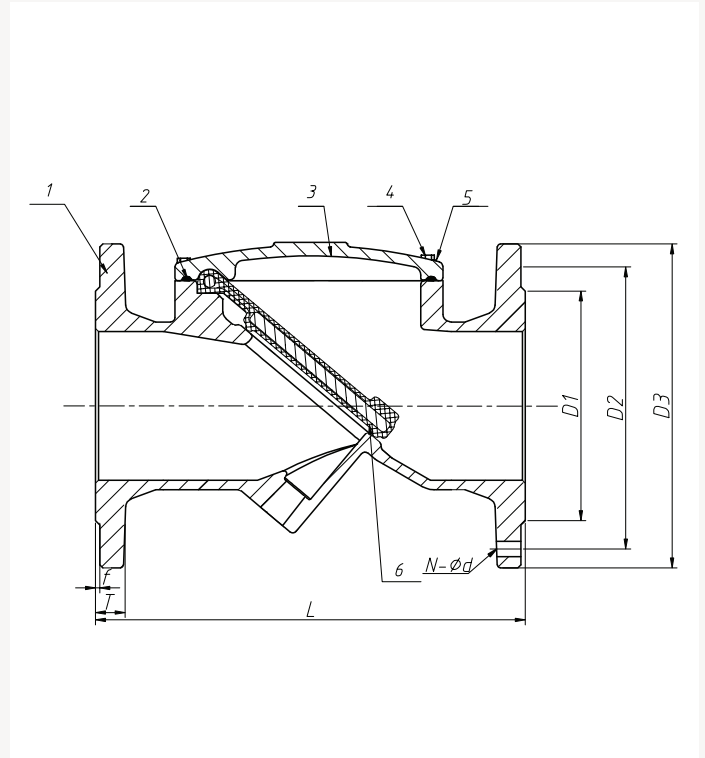

Material specification

CVSF Flex Swing Check Valve 2" to 16"

No	Component	Material
1	Body	Ductile iron GGG40
2	Gasket	Rubber EPDM
3	Cover	Ductile iron GGG40
4	Bolt	Carbon steel + zinc coating grade 8.8
5	Washer	Carbon steel+ zinc coating
6	Disc	Carbon steel fully vulcanised EPDM

Applicable standards:

- Connection standard: EN 1092-2.
- Pressure test standard: EN 12266.
- Face to face standard: EN 558.

Technical data:

- Size: DN 50 - DN 300 (2" - 16").
- Nominal pressure: PN16.
- Temperature range: -5 °C to 85 °C.
- Suitable for water.

Features and benefits:

- 15° sealing angle to ensure low pressure shut-off.
- Suitable for water applications.
- Manufactured from high quality ductile iron.
- Unrestricted flow area for improved flow characteristics and low head loss.
- Designed with an integral EPDM gasket for low and high pressure installation.
- Electrostatically coated with corrosion resistant epoxy powder internally and externally.

CVSF Flex Swing Check Valve

Order code	Size	DN	D1 mm	D2 mm	D3 mm	n-ød mm	L mm	T mm	f mm	Weight (kg)
C0050CFDMN10DO	2"	50	99	125	165	4-ø19	203	19	3.0	9
C0065CFDMN10DO	2.1/2"	65	118	145	185	4-ø19	216	19	3.0	11
C0080CFDMN10DO	3"	80	132	160	200	8-ø19	241	19	3.0	13
C0100CFDMN10DO	4"	100	156	180	220	8-ø19	292	19	3.0	18
C0125CFDMN10DO	5"	125	184	210	250	8-ø19	330	19	3.0	26
C0150CFDMN10DO	6"	150	211	240	285	8-ø23	356	19	3.0	33
C0200CFDMN10DO	8"	200	266	295	340	12-ø23	495	20	3.0	62
C0250CFDMN10DO	10"	250	319	355	405	12-ø28	622	22	3.0	93
C0300CFDMN10DO	12"	300	370	410	460	12-ø28	698	25	4.0	143
C0350CFDMN10DO	14"	350	429	470	520	16-ø28	787	27	4.0	197
C0400CFDMN10DO	16"	400	480	525	580	16-ø31	914	28	4.0	271

* Available in PN10, please contact our sales team for further details.